



Incremental Encoder for special applications

RVI58N-*****1

- Up to 50,000 ppr
- Extended temperature range
- Industrial standard housing Ø58 mm
- Servo or clamping flange
- 10 V ... 30 V with short-circuit proof push-pull output



Function

High performance are key words for this rotary encoder. The outstanding features of this encoder include a high angle resolution and an optional extended temperature range. All six output channels are fitted for this incremental rotary encoder. It can thus be used universally in many different applications. This incremental rotary encoder is available either in clamping flange design with a shaft 10 mm in diameter x 20 mm or in servo flange design with a shaft 6 mm in diameter x 10 mm. The electrical connection is made by a 8-pin or a 12-pin round plug connector. It is also possible to obtain a version with a cable connector.

Dimensions

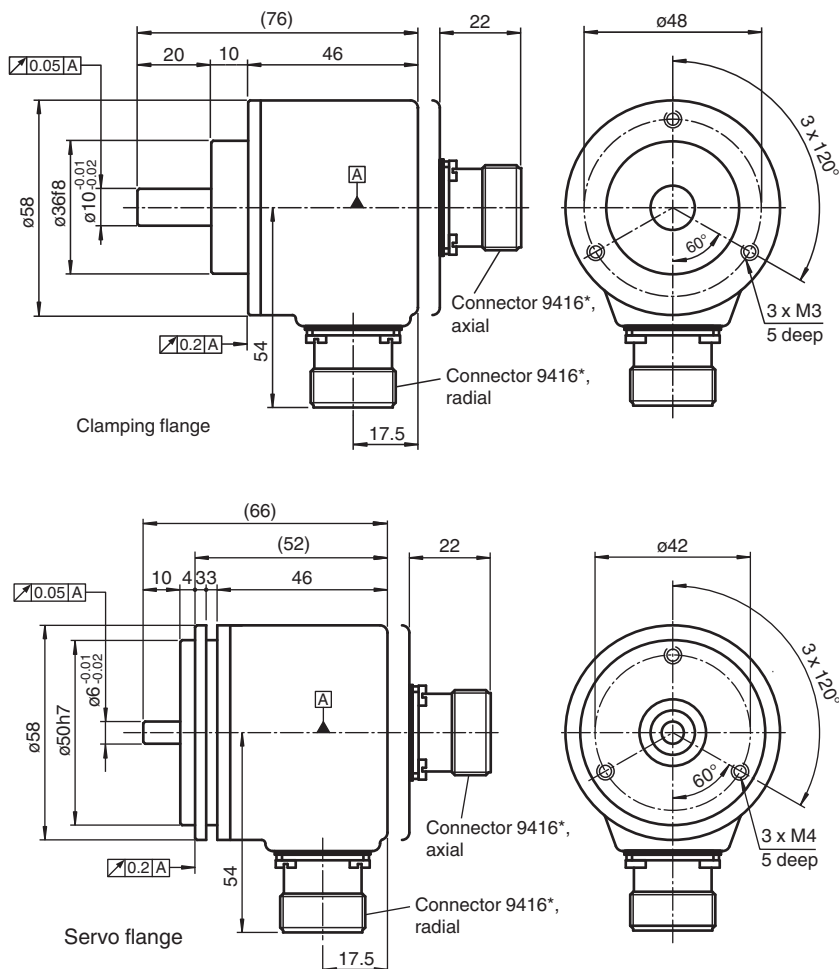

Release date: 2023-03-09 Date of issue: 2023-03-09 Filename: t151797_eng.pdf

Refer to "General Notes Relating to Pepperl+Fuchs Product Information".

Pepperl+Fuchs Group
www.pepperl-fuchs.com

USA: +1 330 486 0001
fa-info@us.pepperl-fuchs.com

Germany: +49 621 776 1111
fa-info@de.pepperl-fuchs.com

Singapore: +65 6779 9091
fa-info@sg.pepperl-fuchs.com

PF PEPPERL+FUCHS

Dimensions

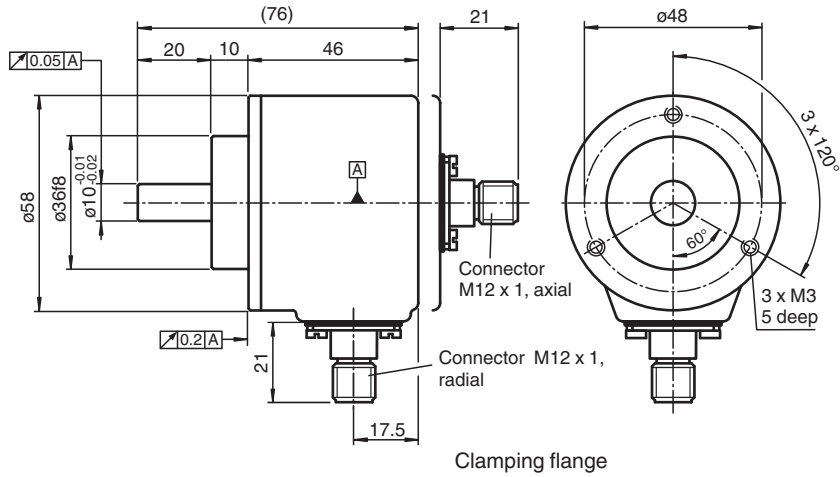

Clamping flange

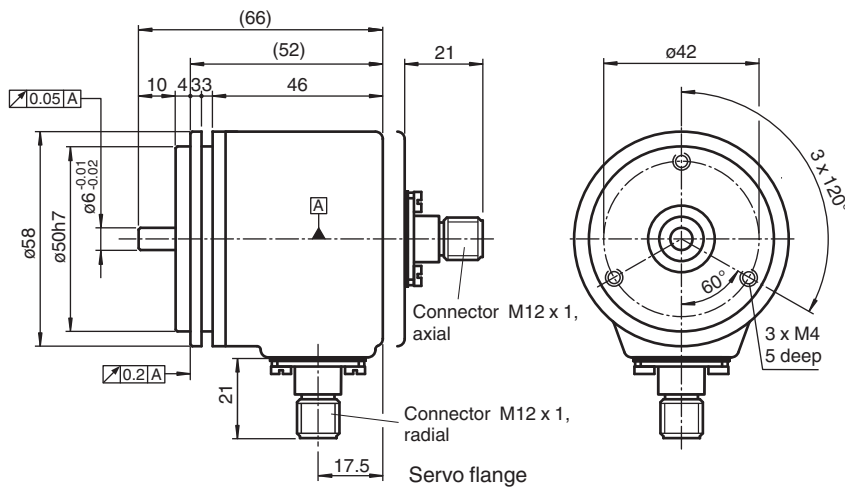

Servo flange

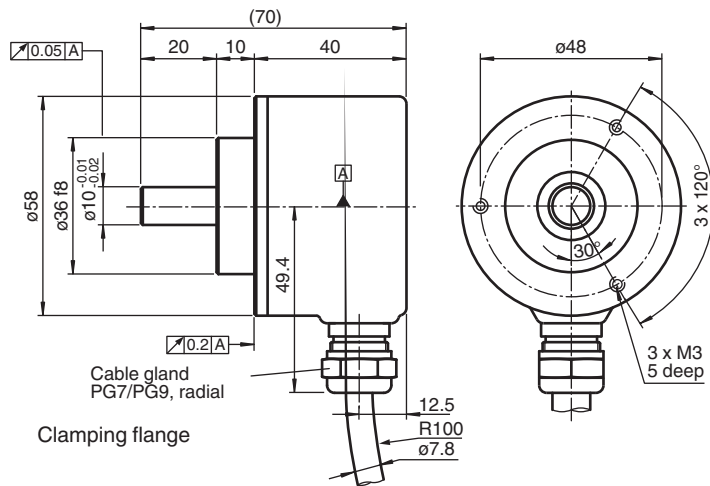

Clamping flange

Release date: 2023-03-09 Date of issue: 2023-03-09 Filename: t151797_eng.pdf

Dimensions

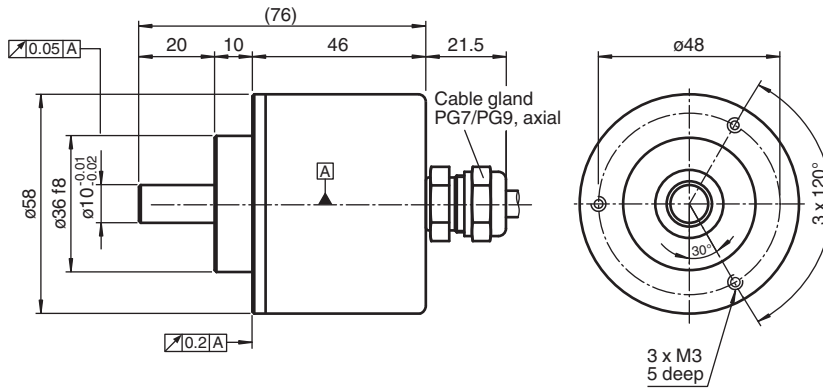

Clamping flange

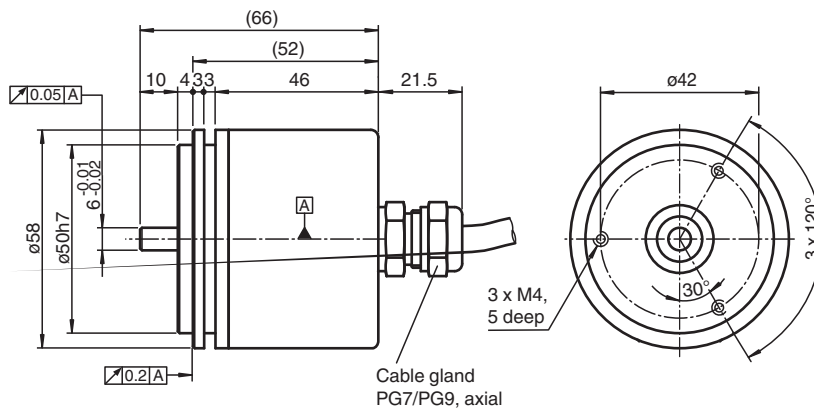

Servo flange

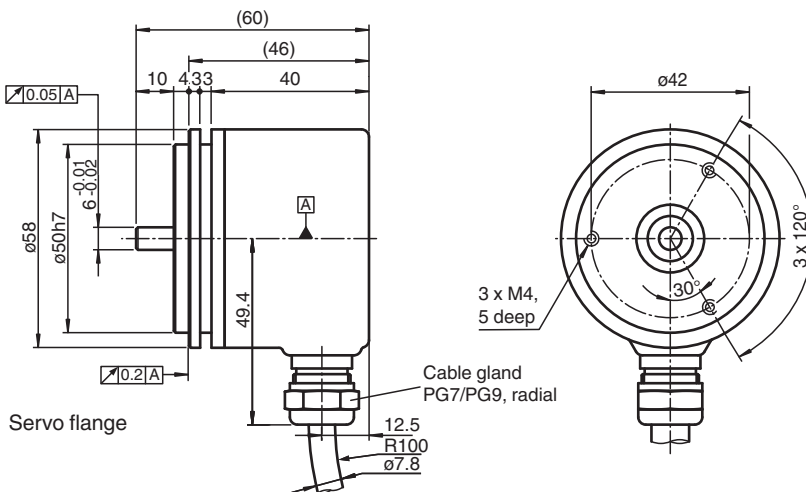

Servo flange

Technical Data

General specifications

Detection type	photoelectric sampling
Pulse count	max. 50000

Functional safety related parameters

MTTF _d	140 a
Mission Time (T _M)	20 a
L ₁₀	70 E+9 at 6000 rpm
Diagnostic Coverage (DC)	0 %

Release date: 2023-03-09 Date of issue: 2023-03-09 Filename: t151797_eng.pdf

Refer to "General Notes Relating to Pepperl+Fuchs Product Information".

Pepperl+Fuchs Group
www.pepperl-fuchs.com

USA: +1 330 486 0001
fa-info@us.pepperl-fuchs.com

Germany: +49 621 776 1111
fa-info@de.pepperl-fuchs.com





Singapore: +65 6779 9091
fa-info@sg.pepperl-fuchs.com

PEPPERL+FUCHS

Technical Data

Electrical specifications		
Operating voltage	U_B	10 ... 30 V DC
No-load supply current	I_0	max. 60 mA
Output		
Output type		push-pull, incremental
Voltage drop	U_d	< 3 V
Load current		max. per channel 40 mA , short-circuit protected, reverse polarity protected
Output frequency		max. 200 kHz
Rise time		400 ns
Connection		
Connector		type 9416 (M23), 12-pin, type 9416L (M23), 12-pin or M12 connector, 8-pin
Cable		Ø7.8 mm, 6 x 2 x 0.14 mm ² , 1 m
Standard conformity		
Degree of protection		DIN EN 60529, IP65
Climatic testing		DIN EN 60068-2-78 , no moisture condensation
Emitted interference		EN 61000-6-4:2007/A1:2011
Noise immunity		EN 61000-6-2:2005
Shock resistance		DIN EN 60068-2-27, 100 g, 3 ms
Vibration resistance		DIN EN 60068-2-6, 10 g, 10 ... 2000 Hz
Approvals and certificates		
UL approval		cULus Listed, General Purpose, Class 2 Power Source
Ambient conditions		
Operating temperature		-5 ... 80 °C (23 ... 176 °F) , movable cable -20 ... 80 °C (-4 ... 176 °F) , fixed cable -40 ... 80 °C (-40 ... 176 °F) with Option T , fixed cable
Storage temperature		-40 ... 85 °C (-40 ... 185 °F)
Mechanical specifications		
Material		
Housing		powder coated aluminum
Flange		3.1645 aluminum
Shaft		Stainless steel 1.4305 / AISI 303
Mass		approx. 350 g
Rotational speed		max. 12000 min ⁻¹
Moment of inertia		≤ 25 gcm ²
Starting torque		≤ 1.5 Ncm
Shaft load		
Axial		40 N at max. 6000 min ⁻¹ 10 N at max. 12000 min ⁻¹
Radial		60 N at max. 6000 min ⁻¹ 20 N at max. 12000 min ⁻¹

Accessories

	9203	Angled flange
	9310-3	Synchro clamping element
	9416	Female cordset
	9416L	Female cordset





















Release date: 2023-03-09 Date of issue: 2023-03-09 Filename: t151797_eng.pdf

Refer to "General Notes Relating to Pepperl+Fuchs Product Information".

Pepperl+Fuchs Group
www.pepperl-fuchs.comUSA: +1 330 486 0001
fa-info@us.pepperl-fuchs.comGermany: +49 621 776 1111
fa-info@de.pepperl-fuchs.comSingapore: +65 6779 9091
fa-info@sg.pepperl-fuchs.com

PEPPERL+FUCHS

Accessories

	9300	Mounting bracket for servo flange
	KW-10/10	Helical coupling
	KW-6/10	Helical coupling
	KW-6/6	Helical coupling
	KW-6/8	Helical coupling
	9401 10*10	Spring steel coupling
	9401 10*12	Spring steel coupling
	9401 6*10	Spring steel coupling
	9401 6*6	Spring steel coupling
	9402 6*6	Spring steel coupling
	9404 10*10	Spring disk coupling
	9404 6*6	Spring disk coupling
	9409 10*10	Bellows coupling
	9409 6*10	Bellows coupling
	9409 6*6	Bellows coupling
	9409 6*8	Bellows coupling
	9410 10*10	Precision coupling
	9410 6*6	Precision coupling
	9102, 10	Measuring wheel for shaft diameter 10 mm
	9103, 10	Measuring wheel for shaft diameter 10 mm









Release date: 2023-03-09 Date of issue: 2023-03-09 Filename: t151797_eng.pdf

Refer to "General Notes Relating to Pepperl+Fuchs Product Information".

Pepperl+Fuchs Group
www.pepperl-fuchs.comUSA: +1 330 486 0001
fa-info@us.pepperl-fuchs.comGermany: +49 621 776 1111
fa-info@de.pepperl-fuchs.comSingapore: +65 6779 9091
fa-info@sg.pepperl-fuchs.com

PEPPERL+FUCHS

Accessories

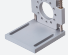
	9108, 10	Measuring wheel for shaft diameter 10 mm
	9109, 10	Measuring wheel for shaft diameter 10 mm
	9110, 10	Measuring wheel for shaft diameter 10 mm
	9112, 10	Measuring wheel for shaft diameter 10 mm
	9113, 10	Measuring wheel for shaft diameter 10 mm
	9108, 6	Measuring wheel
	9109, 6	Measuring wheel for shaft diameter 6 mm
	9110, 6	Measuring wheel for shaft diameter 6 mm
	9113, 6	Measuring wheel for shaft diameter 6 mm
	MBT-36ALS	Spring-loaded mounting bracket with a diameter of 36 mm

Connection

Signal	Cable	Connector 9416	Connector 9416L	Connector M12 x 1
GND	White	10	10	1
U _b	Brown	12	12	2
A	Green	5	5	3
B	Grey	8	8	5
\bar{A}	Yellow	6	6	4
\bar{B}	Pink	1	1	6
0	Blue	3	3	7
$\bar{0}$	Red	4	4	8
U _b Sens ^{*)}	Violet	2	2	-
NC	Grey/Pink	7	7	-
Screen	-	Housing	Housing	Housing
NC	-	9	9	-
GND Sens ^{*)}	Black	11	11	-

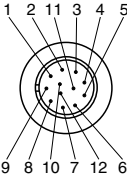
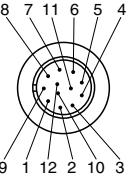
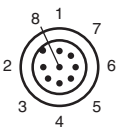
*) only for devices with 5 V supply and RS 422 interface (output circuit 6)

Operation

Signal outputs

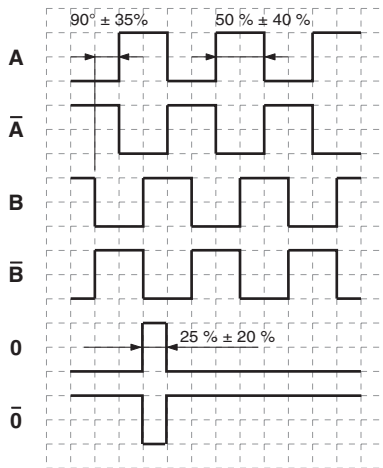

↻ cw - with view onto the shaft clamping ring

Type Code

Release date: 2023-03-09 Date of issue: 2023-03-09 Filename: t151797_eng.pdf



Pulse count 1024, 2048, 2500, 4096, 5000, 8192, 10000, 20000, 50000

Option

- N** Normal
- T** Extended temperature range, -40 °C

Output switching

- 1** 10 V ... 30 V, push-pull
- 6** 5 V, RS 422
- X** 10 V ... 30 V, RS 422

Signal output

- 6** A + B + 0 and \bar{A} + \bar{B} + $\bar{0}$

Exit position

- A** Axial
- R** Radial

Connection type

- AA** Plug connector type 9416, 12-pin
- AB** Plug connector type 9416L, 12-pin
- BE** Plug connector M12 x 1, 8-pin
- K1** Cable Ø7.8 mm, 6 x 2 x 0.14 mm², 1 m

Shaft dimension/flange version

- 011** Shaft Ø10 mm x 20 mm with clamping flange
- 032** Shaft Ø6 mm x 10 mm with servo flange
- 044** Shaft Ø10 mm x 20 mm (flat 1 mm x 20 mm) with clamping flange

Housing material

- N** Aluminium, powder coated

Shaft version

- V** Solid shaft

Release date: 2023-03-09 Date of issue: 2023-03-09 Filename: t151797_eng.pdf